

Hargrave 68

FRANKLY MY DEAR, IT'S AN ELEGANT CUSTOM-MADE YACHT
BY TOM THOMPSON

THE MANSION IN THE MOVIE “Gone With the Wind” was a venue of gracious entertainment. It was in that same spirit of Southern hospitality that the owner of a 68-foot Hargrave Capri series motor-yacht named his boat *Tara*. Working with the design team at Hargrave Custom Yachts, the owner created a superb place for guests to enjoy time together on the water.

Tara's deck layout was planned for entertaining large groups of people. Although there are only three staterooms for overnighting, the elegant surroundings of the saloon and flybridge accommodate large parties. The middle of the upper deck has large L-shaped sofas with tables in front of them along each side. Between that and the helm area forward, there's a large granite-topped bar with three fixed bar stools. A Stidd helm seat is mounted on the centerline and is flanked by two-person sofas to each side that face forward. Eighteen people can be seated and half again as many can stand on the flybridge with-

out feeling confined. A hardtop covers most of the deck. At the aft there's open space for a tender and a davit.

Open-air entertaining is also available on the main deck. The spacious cockpit, which is covered by the flybridge overhang, has a large dining table. Four chairs are arranged on three of its sides. A bench running the length of the transom serves as seating along the fourth side. Steps at either side lead down to the swim platform. And here comes an interesting little surprise. Turn and face forward. Take a step toward the glass sliding doors to the saloon and they open automatically.

INTIMATE, CLASSY

Tara's saloon makes an elegant use of wood. The high-gloss cherry with camphor burl accents creates a rich feel that contrasts well with the large expanse of granite countertop in the galley area. Seating and standing room are proportioned about equally. There is a sofa to port and three single chairs that can be placed as needed. There are two fixed bar stools along the aft leg of the U-shaped galley countertop positioned athwartships and to port. Storage cabinets above follow the counter lines, while additional counter space runs along the starboard side — an ideal place to serve a buffet meal. The galley boasts two undercounter refrigerators and one freezer, along with a complete array of other appliances. Another of the little surprises aboard *Tara* is a dumbwaiter in one corner of the galley that can send meals to the flybridge.

An Inside Look

The pilothouse is forward of the galley. A cozy seating nook with a small table is positioned in the port corner. The elegant use of wood continues at the lower helm station. The console is crafted like a fine piece of furniture. All of the controls and electronics are well arranged on burl wood panels. There's another Stidd helm seat behind the wooden steering wheel. Watertight doors on either side access the side walkways. The foredeck features a cushion pad for sitting or sunning. Storage compartments along either side of it are about the size of a small car's trunk.

The lower deck of *Tara* contrasts with the others in that it's cozy and intimate. That's not to say, however, that it's small. The full-beam master stateroom has a king-size bed at its center. The boat's 18-foot, 6-inch beam provides plenty of room for amenities. There are his and hers walk-in wardrobes, a dressing table, plenty of drawers and a closet that holds a washer/dryer combo.

The nautical term "head" is probably inappropriate to describe *Tara*'s bath facility. The space extends across the boat's beam and features his and hers vanities and toilets separated by the 4-foot wide shower between them. To use the term "head" in another context, the shower has two of them, so there's no waiting. The wood motif continues in the master suite, and is complemented by marble countertops and floors in the bath. Are you ready for another of those little surprises? At the touch of a button, a large, flat-screen TV rises from the master suite bed's footboard.

Despite the VIP suite's position forward in the bow, it is very spacious. The double berth is accessible from three sides and there is ample room to walk around. The en suite head also features marble countertops and flooring. There's also a day head on the lower deck, conveniently located at the base of the stairway down from the pilothouse.

An additional stateroom is located at *Tara*'s stern, accessible from the swim platform. Ordinarily this would be crew quarters, but because *Tara*'s owner operates the boat as well, the space is configured for guests. There

TESTER'S OPINION: "It's easy to see why over half of Hargrave's sales come from previous owners. The level of quality in the interior appointments on *Tara* was outstanding. The woodwork is what really makes this boat."



FROM THE TOP — Hargrave's customized interiors on board the classy 68 include ample seating for guests around the helm, a spacious, open saloon with rich woods and fabrics, a galley with more counter space than you find in some homes and comfortable accommodations for owners and their guests.

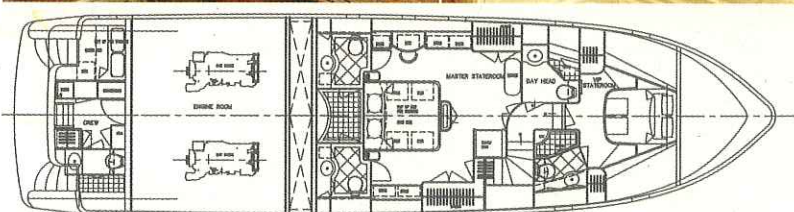

Hargrave 68

SPECIFICATIONS

LOA	68 ft.
Beam	18 ft., 6 in.
Draft	5 ft., 8 in.
Weight (dry)	100,000 lbs.
Deadrise	12 degrees
Fuel capacity	1,572 gals.
Water capacity	280 gals.
Engines	twin C-18 1,000 hp (each) Caterpillar diesels
Base price	\$2,061,810
Price of boat as tested	\$2,365,122

PERFORMANCE SPECS

Top speed	21 knots
Fuel burn @ 2,000 rpm cruise	49.3 GPH per engine
Range @ 18 knot cruise	400 nautical miles w/10% reserve

CUSTOMIZED FEATURES

Second generator, Glendinning Cablemaster, automatic cockpit door, Naiad stabilizer, oil exchange system, bow thruster, upgraded air-conditioning system, upgraded sound and heat insulation materials, upgraded galley appliances.

CONSTRUCTION

Hull is solid fiberglass. Sides and deck are fiberglass with divinyl core.

COMPANY PROFILE

Years in business	35
Number of employees	20
Boat lines	Hargrave

BUILDER

Hargrave Custom Yachts, Ft. Lauderdale, FL; (954) 463-0555; www.hargrave.org

WEST COAST OFFICE

Hargrave Custom Yachts, Seattle, WA; (206) 390-2577; brian@hargrave.org



ROOM TO MOVE — Guests aboard *Tara* enjoy the great outdoors with plenty of unique seating arrangements that include bar stools and tables with drink holders.

is a bunk berth, the larger of the two being on the bottom, a nightstand and a chest of drawers in a compartment to port. A head is on the starboard side. It contains a stall shower and features granite accents.

COMFORTABLE CRUISE

The door to *Tara's* engine room is in the bulkhead forward of the crew quarters. The space is impressively large and easy to move around in. A walkway runs down the center. It sits on stringers about 8 inches above the hull bottom and there's more than 6 and 1/2 feet of headroom when you're standing on it.

The boat's two generators are mounted outboard of the engines, yet there is plenty of room to move around and everything seems to be out where you can reach it. *Tara* is powered by a pair of Caterpillar C-18 diesels, each rated at 1,000 hp. The boat has a top speed of 21 knots

and will cruise 400 nautical miles at an 18-knot cruising speed. The hull is not so much designed for speed as it is for a smooth and comfortable ride.

GOING THE EXTRA MILE

Vision plays an important role in designing a custom motoryacht, and *Tara's* owner certainly had such vision. The living spaces provide ample room to move about yet are done in a décor that exudes warmth and intimacy. *Tara* is a good example of Hargrave's capabilities.

Some builders may use the term custom to mean they'll change carpeting and draperies, but Hargrave will go the extra measure to let the owner place his or her mark on cabin dimensions and deck design. That's a surprise of the most pleasant kind when the results are in. 🐾

📞 **CONTACT: HARGRAVE CUSTOM YACHTS,**
FT. LAUDERDALE, FL; (954) 463-0555;
WWW.HARGRAVE.ORG

ANNUAL RENDEZVOUS GUIDE

Sea[®]

America's Western Boating Magazine

**Be Sure and
Secure**

Keep Your Boat
Crime Free



Hargrave 68



Cranchi Atlantique 48



McKinna 48 Sedan



Hatteras 68C

May 2005
goboatingamerica.com

\$3.99 US / \$4.99 Canada

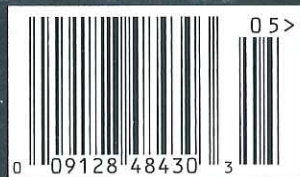

Display until 05/31/05